

# PORTFOLIO

**SAYAKA AKAYAMA**

Faculty of Environmental Sciences,  
Nagasaki University

bb53618001@ms.nagasaki-u.ac.jp

# SELECTED WORKS

1. RESEARCH

2. STREETScape

3. DINO PARK

4. COMMUNITY PARK

5. LANDSCAPE DESIGN CHARETTE

6. PRIVATE GARDEN

7. HOBBY: RUBBER CARVING

Nagasaki is filled with natural and historical sites. However, it faces depopulation. I have seen Nagasaki's various aspects and took part in projects to deal with its issues. My works below show what I experienced in Nagasaki.





# 1. RESEARCH

## The Landscape Protection between Yellowstone National Park and Unzen-Amakusa National Park

Graduate thesis for Nagasaki University/Submitted in February 2018



In my thesis, I compared the landscape protection between Yellowstone National Park (hereinafter referred to as Yellowstone), the first national park in the world, and Unzen-Amakusa National Park (hereinafter referred to as Unzen), one of the first national parks in Japan. Although these two national parks are both attractive and have geological similarities, the number of visitors in Yellowstone has been increasing whereas that of Unzen has been decreasing over past years. My research was to study the characteristics of these parks to reveal existing problems of Unzen and solve the problems with landscape design.

From my survey, there were no substantial differences between visitors' interests in Yellowstone and Unzen. However, the lack of facilities and trails discouraged tourists in Unzen. For tourists, it is difficult to get to the site by themselves because of the lack of signage, so it does not fully attract people despite of having a vast

amount of cultural landscape. The site has a big potential to succeed in attracting tourists if they have a good landscape design. Considering the recent increase of individuals or small groups of visitors, Unzen needs to improve its landscape design including zoning, circulation, signage plan, and programs concerning the whole area.

The drawing above is one of my proposed landscape designs, the entrance area to a historic water fall called "Issaikyo-no-taki". The current condition is the example of lacking the signage on the way to the site. Even if people can reach the entrance, it is not easy to find their way to the water fall. In addition, there is no parking. I proposed a pocket park including parking lot, with the signage and water displays. The repetition of the gates provide mist and which indicates the beautiful splash of waterfall at the destination.



# 1. RESEARCH

## The Landscape Protection between Yellowstone National Park and Unzen-Amakusa National Park

The highlight of this thesis is a comparison by a questionnaire survey about the visitors' interests in each park. I conducted a survey in Unzen while referring to the thesis by William T. Borrie, et.al. (2002). According to the table below, there were no significant differences between Yellowstone and Unzen visitors' interest. Each item was evaluated on a scale of 1 to 5, and graphs illustrate items of interest by each generation. It was clear that the number of visitors in Unzen, interested in exploring nature individually or in small group, is increasing. However, Unzen is

not designed to accommodate small groups or individual visitors. Therefore, from the survey result, we can say that unfriendly landscape for individual tourists in Unzen causes problems despite of having abundant touristic resources as much as Yellowstone.

**Main geyser of Unzen/**Although this is the important site in the history of Japanese hidden Christians and main source of hot springs in Unzen, some industrial-looking pipes are seen in the natural landscape, which discourage visitors.



The Visitors' Interests survey result

Items/Average	Yellowstone	Unzen
Have adventure	4.03	3.68
Be with members of my own group	3.75	3.86
Enjoy natural scenery	4.77	4.45
Learn about natural history	3.97	4.14
Get away from the usual demands of life	4.22	4.22
Enjoy hot springs	—	4.69

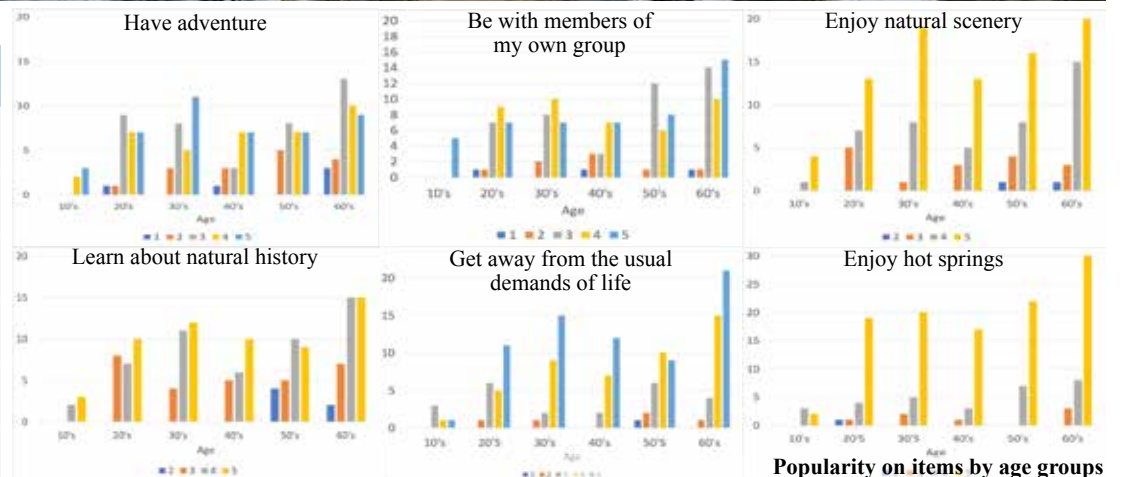



## 2.STREETSCAPE

Individual Studio Project

2weeks/ October 2018/Teramachi, Nagasaki city

Professional work, construction is going to start in 2019

This project was worked with Nagasaki city



An old picture of the site

Teramachi is a historic district in downtown Nagasaki. It is the base for the Okunchi-festival, which is one of the biggest and most traditional festivals in Japan. However, in a current situation, no one can feel such historical atmosphere anymore. The project is meant to bring the historical atmosphere back to the streetscapes and encourage people to walk more.



The concept is to show each town district's characteristic by a banner in the street. Each district has different culture and have their own bridge and temple. Because each district presents their own performance in the festival, I used the logo of the performance in the design of the districts' banner.

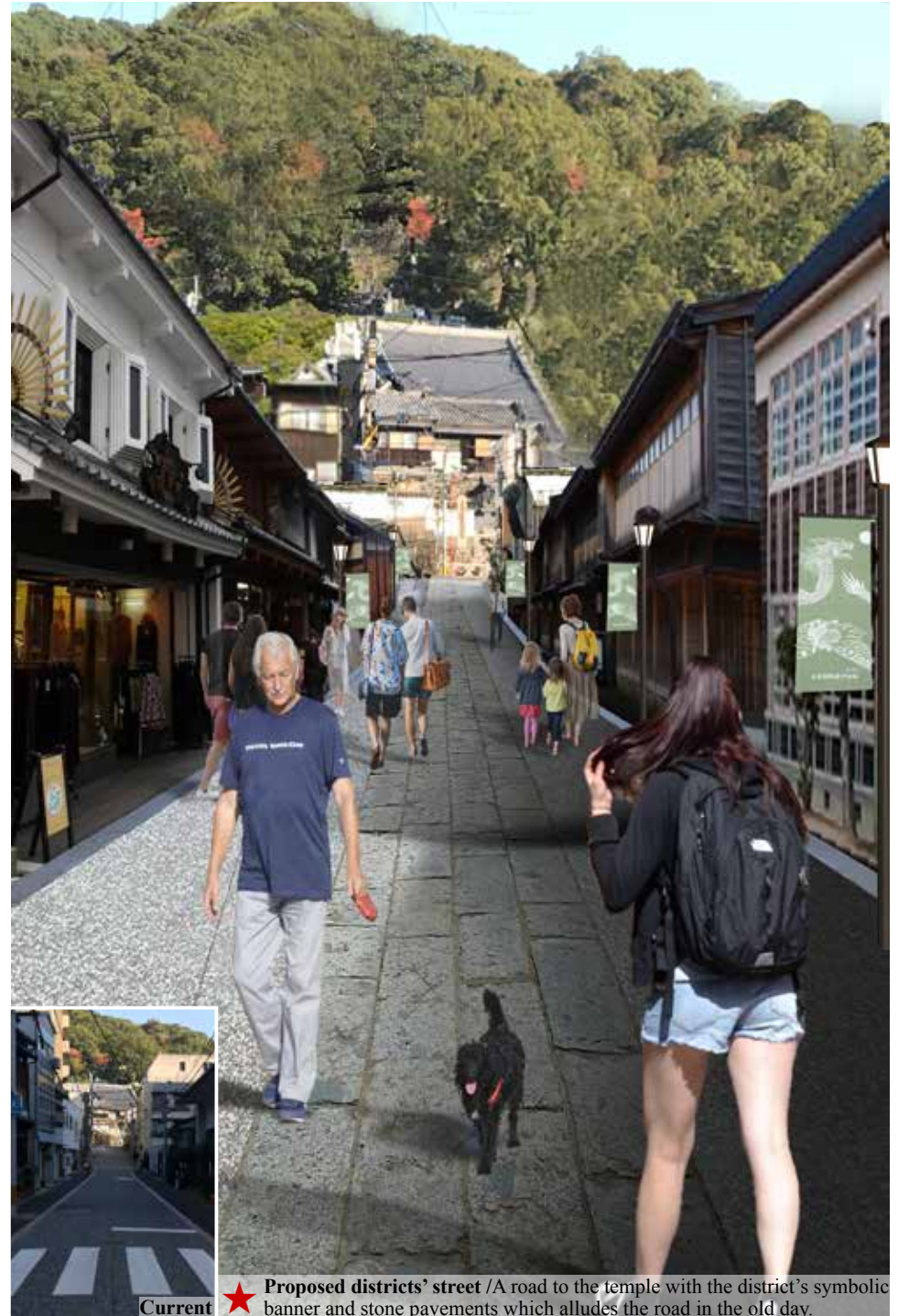

Current

★ Proposed districts' street / A road to the temple with the district's symbolic banner and stone pavements which alludes the road in the old day.



## 2-1.STREETSCAPE

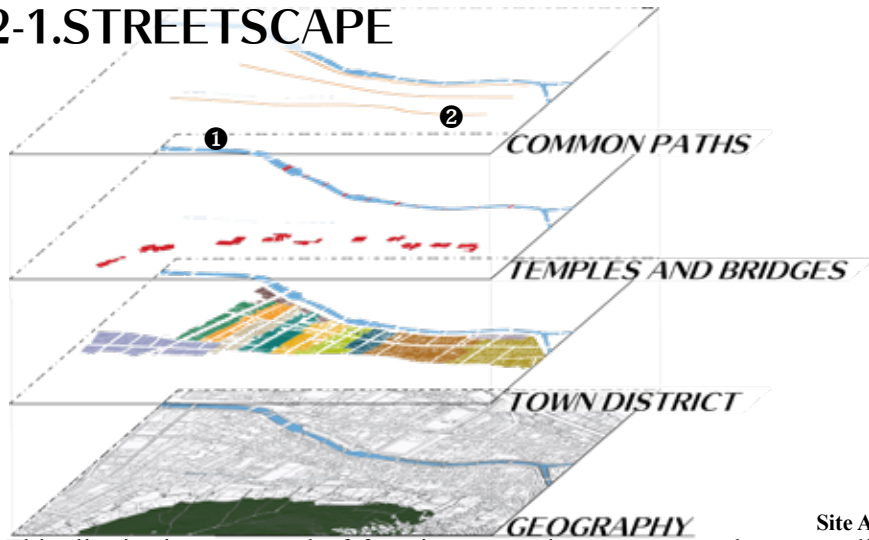

Site Analysis

This district is composed of four important layers; geography, town district, temples and bridges and common path. The town district layer shows how each district is divided as a performance group at the Okunchi-festival. The temple layer shows how they are connected to each district. The proposed banners in each street are located based on this diagram.



**1** Proposed pocket park/ Resting space for people to access digital information.

## 2-2.STREETSCAPE

Studio Project

2weeks/ October 2018/Riv.Nakashima, Nagasaki city

Constriction is going to start in 2019

Designed by our seminar group



**2** Proposed waterfront street/ By redesigning street trees and sidewalk, the view to the river is opened.

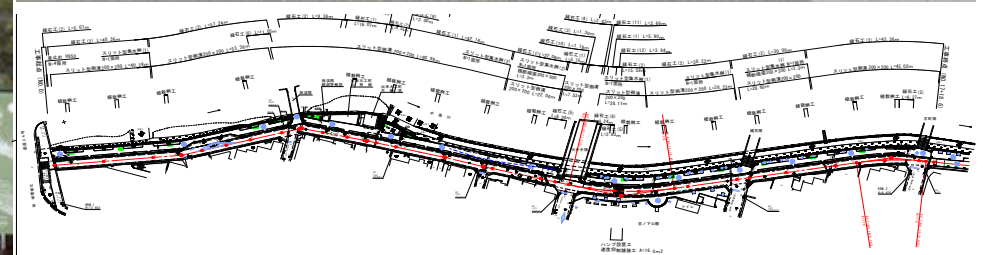

Proposed construction drawing

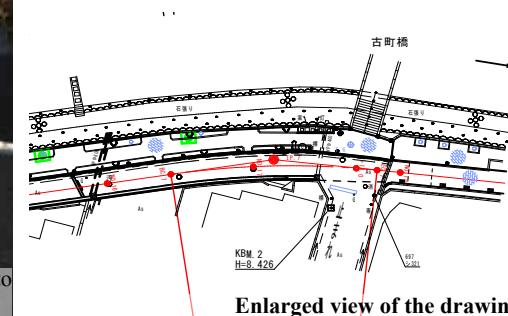

Enlarged view of the drawing



Current



### 3. DINO PARK

Group Workshop/5weeks/ July 2018/Nomozaki, Nagasaki city/Professional work, construction is going to start in 2022.This project was worked with Nagasaki city

Nomozaki is located 50 minutes away from downtown Nagasaki and is facing issues related to depopulation, aging society, and shortage of work place even though you can enjoy beautiful scenery of Hashima, battleship island where movies were filmed, for example 007, and thousands of Narcissus flowers which bloom in January. When dinosaur bones were excavated in the area, the project

started to revitalize the local tourism by constructing a new comprehensive dinosaur park and dinosaur museum. Our proposal aims to combine the fabulous landscapes of Hashima and flowers and dinosaurs to encourage tourism. We proposed new road, zoning, museum, circulation proposal, planting plan and programs to target a wide age range of visitors throughout the year.



Distance from Nagasaki



**Proposed interior view of the museum/**  
People can take a picture with dinosaur skeleton and Hashima at once.



**Planting plan/**

It will attract visitors throughout year, and plants are transferred from botanical garden nearby which will be demolished in 2019.



### 3. DINO PARK



Proposed Dino park, museum and other comprehensive area



Seasonal blooms and annual events proposal/

We proposed the various programs such as summer kids camp, farmers' market and art events, etc. which entertain both tourists and local residents.



**Photo spots**/Putting dinosaur installations in each area encourages visitors to explore the whole area with the sense of treasure hunts.

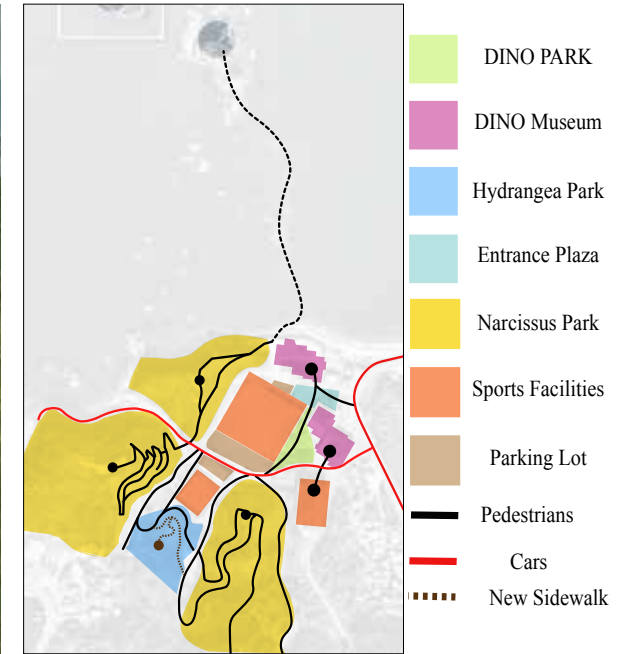

Circulation and zoning diagram

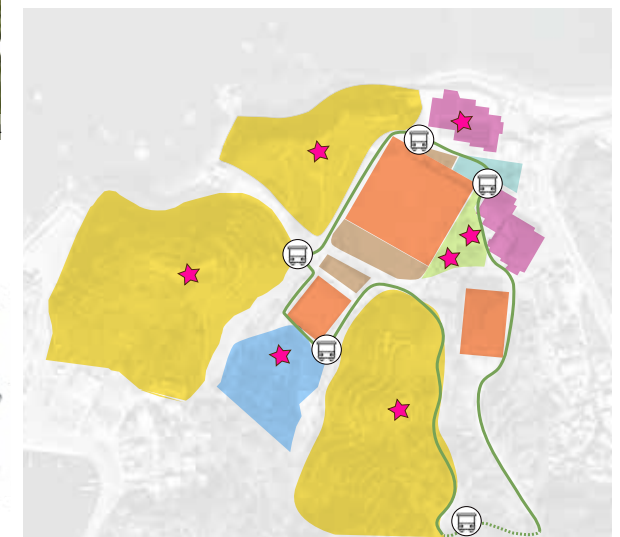

**Shuttle bus route diagram**/Shuttles are driven by local residents such as retired people and this program helps a sustainable tourism there.



## 4.COMMUNITY PARK

Individual Studio Project/2weeks/ July 2017/Heiwamachi, Nagasaki city  
Constriction is going to start in 2019.

This project was worked with Nagasaki city and by having workshops with local community, dealt with their needs.



Proposed plan view of the Tenshu Park and Urakami Cathedral

Tenshu Park is located in front of Urakami Cathedral, which is one of the Nagasaki's historical churches with a long history of hidden Christian legacy. It is located 500 meters north of the hypocenter. Although the park is located in the middle of such a historical area, it does not play a role in accentuating its history and not so many people use the park. Thus, this park needs to visualize its history as a passage to connect the hypocenter and Urakami Cathedral and should provide the historical information to tourists. At the same time, the park should serve for various needs of local residents as a community park. This project was to solve these issues with the local community by having several workshops and discussions with them. The main feature of this park is an amphitheater and the axis which connects the hypocenter and Urakami cathedral. Lighting elements, including recreational equipment, also emphasize the axis. There is a small memorial in a pool on the underground parking to pass down to the future generation about the memory of WWII.



Zoning diagram/

Grass area amphitheater play equipment area

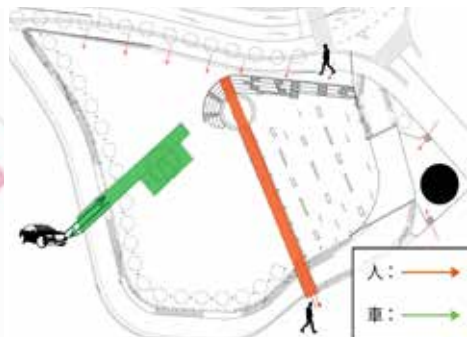

Pedestrians flow and underground parking diagram



The general view of amphitheater/ People watching stage performance from the sidewalk and stairs



Images of lighting elements



The seasonal view of amphitheater/The park can be used as a public space for local events or festivals. Movable stands are available for these occasions.



## 4.COMMUNITY PARK



General view of proposed park

By using the difference of elevation, an underground car parking lot for 5 cars was designed. There is a small pool with a stone monument for victims of WW2.



Image for civic center

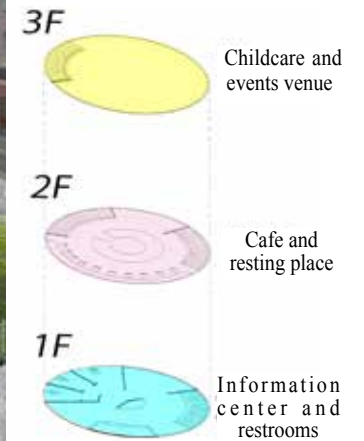

**Proposed civic center/** It is an information center and community space for both tourists and local residents.



Workshop with local community

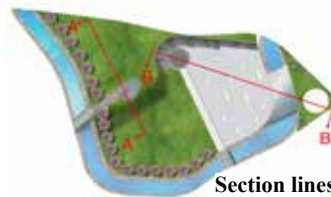

Section lines



Model for the workshop



Section BB'/From civic center to the amphitheater

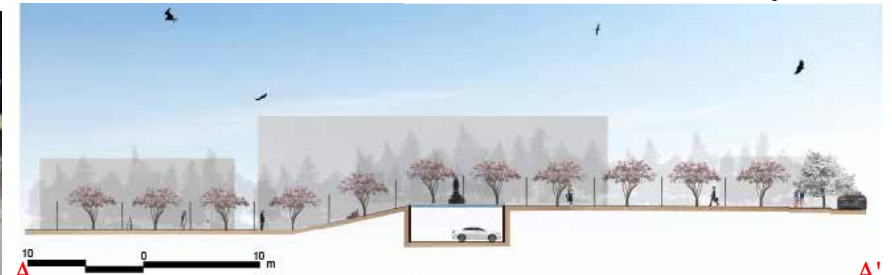

Section AA'/Through the underground parking lot



## 5.WAKABA TERRACE NURSING HOME GARDEN

Individual Drawings/November 2018/Sasebo city, Nagasaki pref.

Construct completed in May, 2016

This Japanese garden was designed in a retirement home by Dr. Seiko Goto.

I worked for drawing a plan and sections.

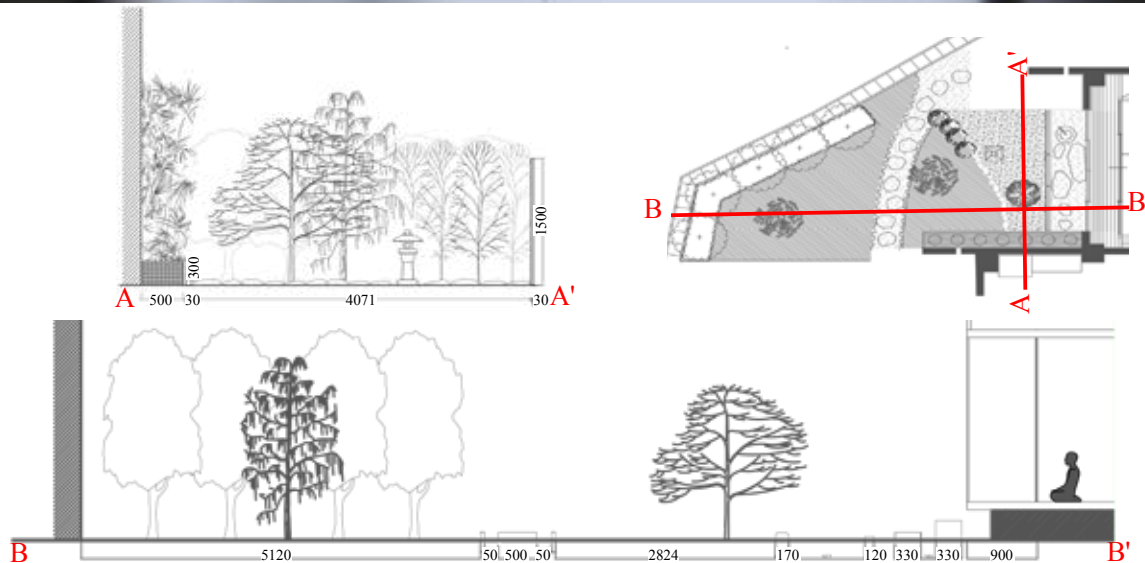
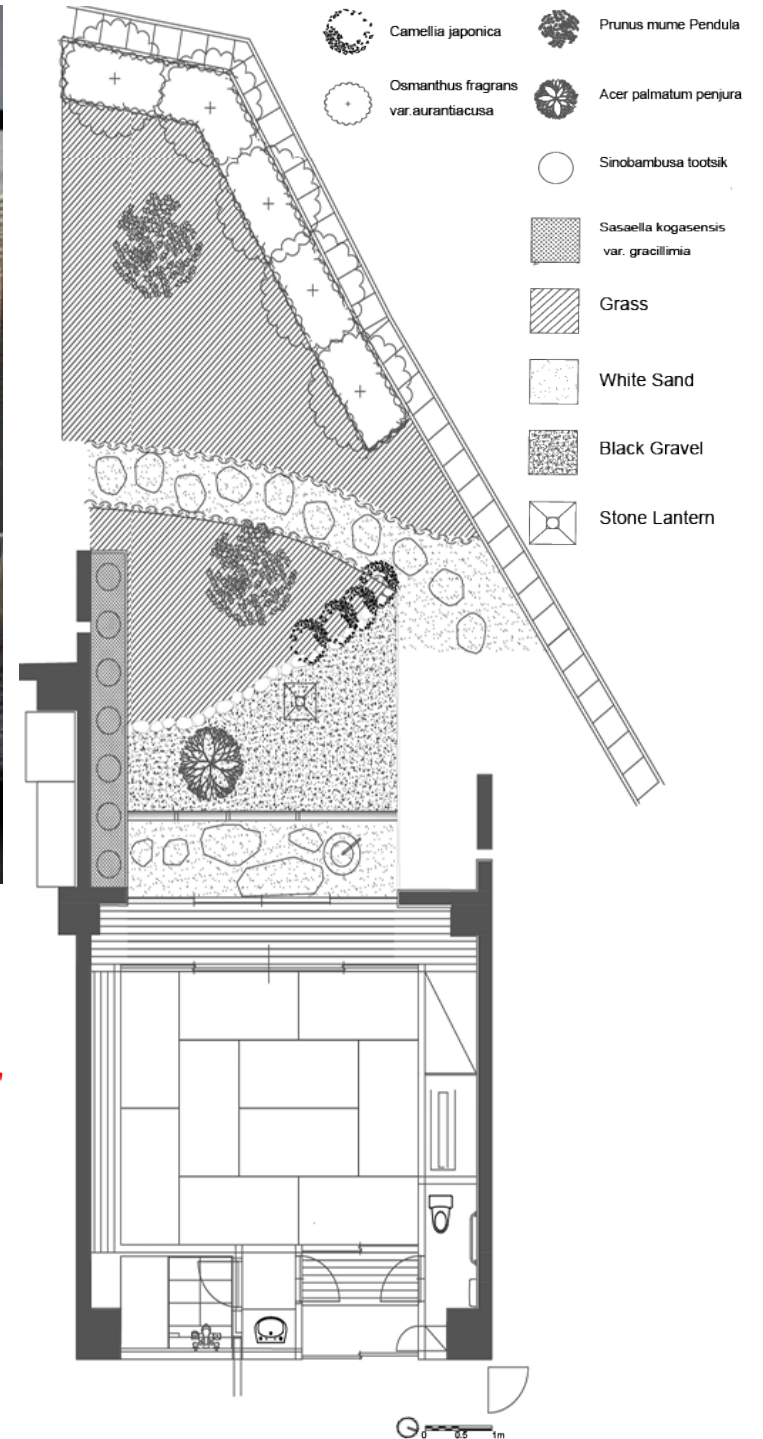



## 6. LANDSCAPE DESIGN CHARETTE

Group Workshop/4 days/ August 2018

The public square in front of civic center in Nagasaki city

Thinking with Nagasaki city, the charette was conducted by a society for study of landscape design.



Model

The workshop was to design a public square in front of the civic center and city hall's new building. The biggest challenge was to determine how to connect the two spaces divided by a road. Our team proposed the space with a long bench along with grass to accent the pathway behind of the civic center where we have the historic bridge; the double-arched Megane-bashi, or Spectacles Bridge.



Model



Proposed pathway behind the civic center



Site Analysis



Concept making





## 7.HOBBY:RUBBER CARVING

I started carving rubber stamps when I was eight years old. Since then, I used my stamps for New Year's cards and Christmas cards every year. Each one is associated with a Chinese zodiac or something that brings luck.



I have been interested in graphic art and crafts in my life which I believe useful for the presentation of landscape design.